

BROWN ST

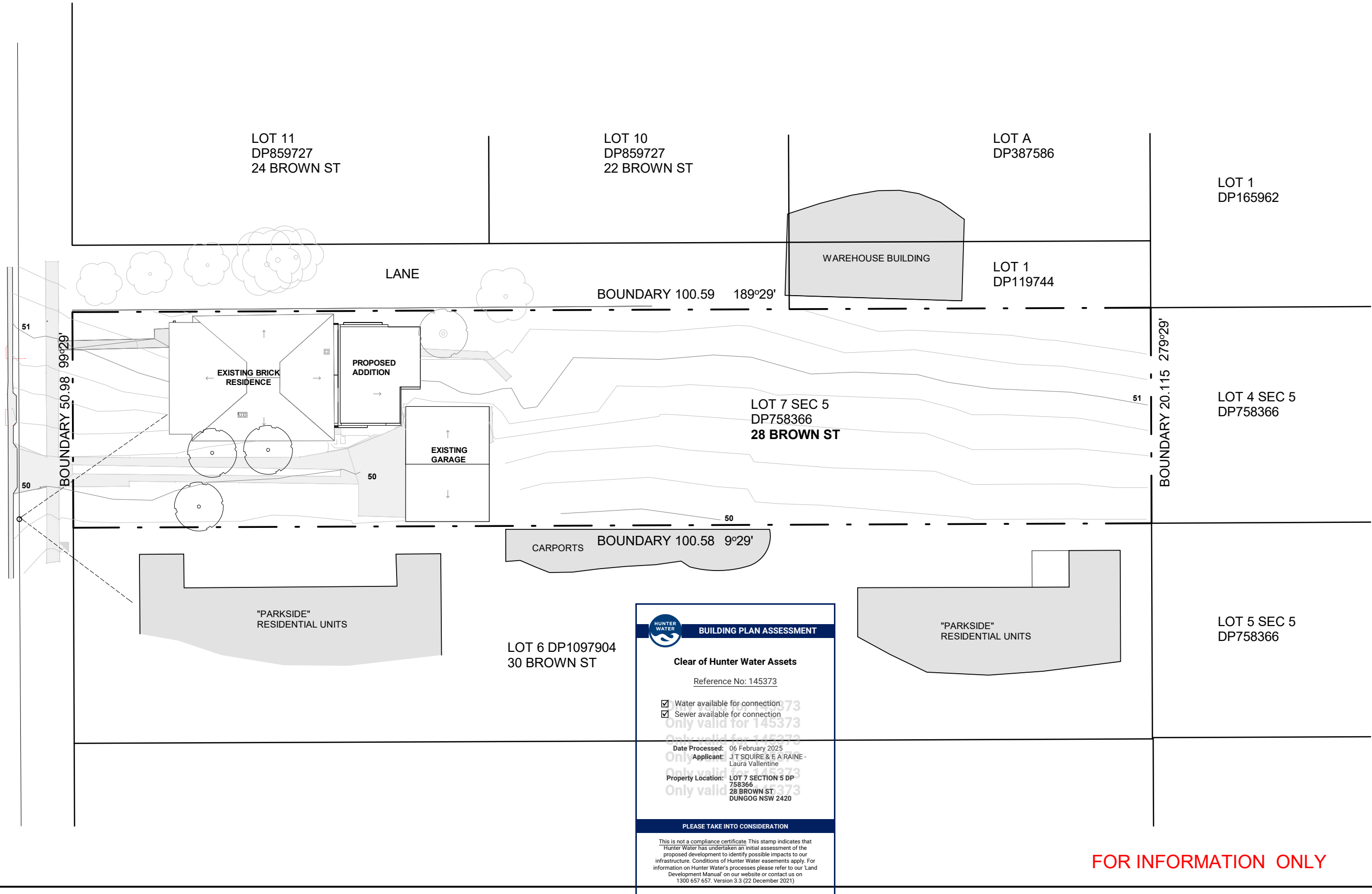

LAURA VALLENTINE ARCHITECT

ABN 83 259 118 965
NOMINATED ARCHITECT NSW 9262

lauravallentine.com

NOTES

1. DO NOT SCALE OFF DRAWING. WRITTEN DIMENSIONS GOVERN.
2. ALL DIMENSIONS ARE IN MILLIMETERS UNLESS NOTED OTHERWISE.
3. THE BUILDER/CONTRACTOR SHALL VERIFY ALL WRITTEN DIMENSIONS PRIOR TO ANY WORK COMMENCING. LAURA VALLENTINE ARCHITECTS SHALL BE NOTIFIED IN WRITING OF ANY DISCREPANCIES PRIOR TO THE COMMENCEMENT OF ANY WORKS.
4. THIS DRAWING IS AN UNCONTROLLED COPY, UNLESS NOTED OTHERWISE.
5. THIS DRAWING MUST BE READ IN CONJUNCTION WITH ALL RELEVANT CONTRACTS, SPECIFICATIONS AND DRAWINGS.
6. LAURA VALLENTINE ARCHITECTS MAKES NO WARRANTIES OF FITNESS FOR ANY PURPOSE.
7. THE RECIPIENT AGREES NOT TO USE THIS DOCUMENT FOR ANY PURPOSE OTHER THAN ITS INTENDED USE. TO WAIVE ALL CLAIMS AGAINST LAURA VALLENTINE ARCHITECTS RESULTING FROM UNAUTHORIZED CHANGES OR TO REUSE THE DOCUMENT FOR ANY OTHER PROJECT WITHOUT THE PRIOR WRITTEN CONSENT OF LAURA VALLENTINE ARCHITECTS.

© COPYRIGHT OF THIS DRAWING IS VESTED IN LAURA VALLENTINE ARCHITECTS 2025

No.	Description	Date

ADDRESS

28 BROWN ST DUNGOG NSW 2420

PROJECT

ALTERATION & ADDITION TO EXISTING RESIDENCE

CLIENT

ELIZABETH RAINE & JOHN SQUIRES

DRAWING TITLE

SITE PLAN_PROPOSED

DRAWING No.

DA_100

PROJECT No.

2407_050

REV.

NORTH



SCALE

1 : 350





HUNTER WATER CORPORATION

A.B.N. 46 228 513 446

Developer Plan

Enquiries: 1300 657 657



RATEABLE PREMISE NO.: 1427703301

LOT/SECTION/DP: Lot 7 Section 5 DP 758366

PROPERTY ADDRESS: 28 BROWN ST, DUNGOG NSW 2420

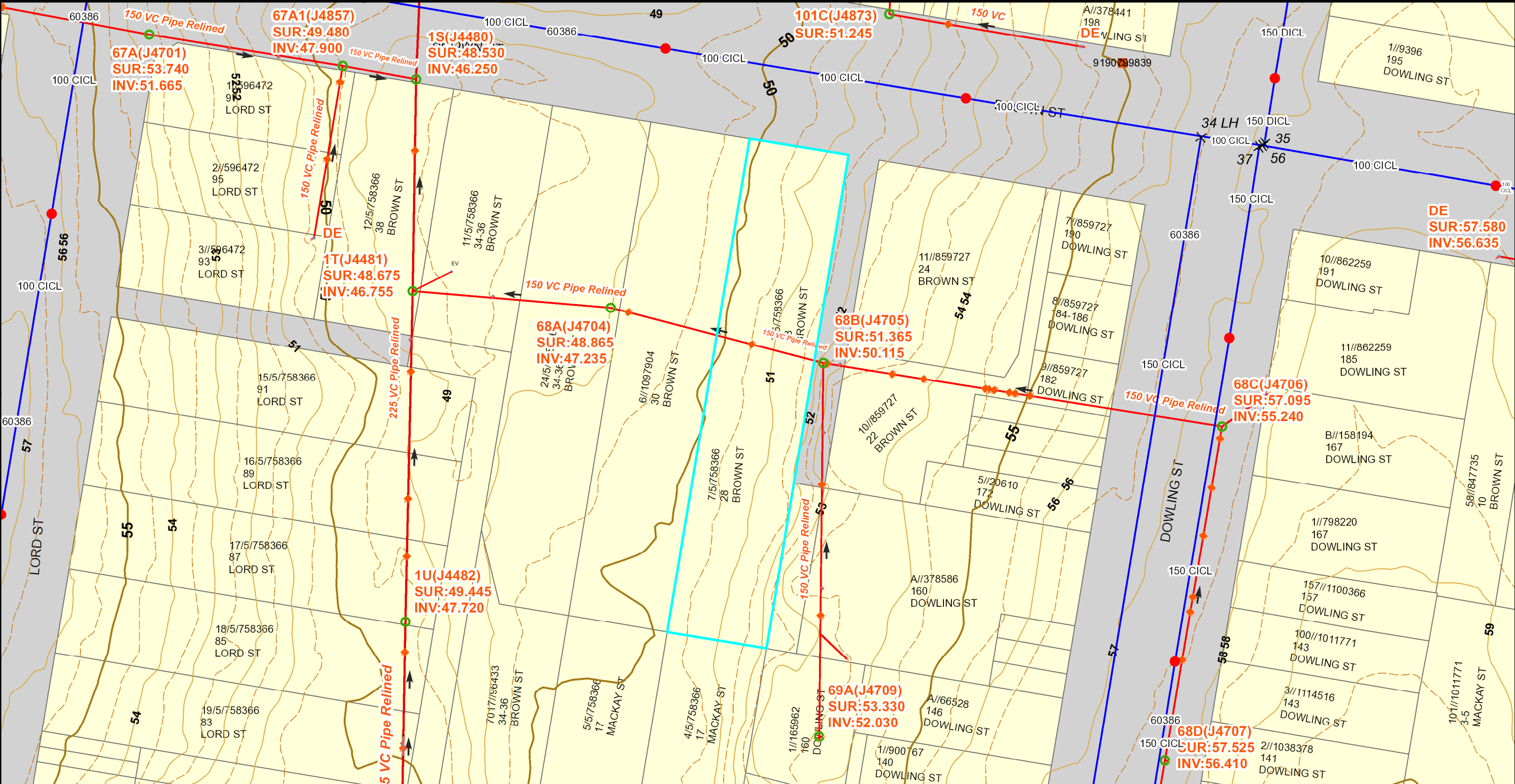

Date: 31/01/2025	CADASTRAL DATA © Department Finance, Services & Innovation [Nov 2017]. Modified [31/01/2025] AERIAL DATA © NearMap CONTOUR DATA © AAMHatch © Department of Planning	SEWER/WATER/RECYCLED WATER/ELECTRICAL UTILITY DATA © HUNTER WATER CORPORATION	HUNTER WATER ASSETS POSITION ARE APPROXIMATE ONLY. SUBJECT PROPERTY BOLDED. ALL MEASUREMENTS ARE METRIC.	IMPORTANT: ANY INFORMATION ON THIS PLAN MAY NOT BE UP TO DATE AND THE CORPORATION ACCEPTS NO RESPONSIBILITY FOR ITS ACCURACY.
Scale: at A3 1:750				